

ELEMENTS SQUARE CONTEMPORARY DEADBOLT - GDC9471

Box Pack Specifications



SATIN NICKEL



SATIN CHROME



POLISHED CHROME



MATTE BLACK



These finishes are available with Microban anti-microbial coating: 15 and 514



GDC9471		 20 min.	Satin Nickel	Polished Chrome	Satin Chrome	Matte Black
Single Cylinder	GDC9471 SQT	<input type="checkbox"/>	<input type="checkbox"/>	<input type="checkbox"/>	<input type="checkbox"/>	<input type="checkbox"/>

SPECIFICATIONS



20 min.

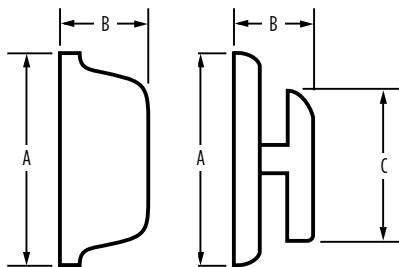

Door Prep	Cross Bore 2-1/8" Edge Bore 1" Latch Face 1" x 2-1/4"
Backset	Adjustable to 2-3/8" or 2-3/4"
Door Thickness	SMT 1-3/8" - 1 3/4" KW P&T 1-3/4"
Cylinder	SmartKey or KW 5-pin
Faceplates	1" x 2 1/4" Specify round corner or square corner or drive-in"
Strikes	1-1/8" or 2-3/4" Specify round corner or square corner
Bolt	1" throw
Door Handing	Reversible for right or left-handed doors
ANSI/BHMA	A156.5 Grade 3
ADA	Interior turn piece meets 4.13.9 ADA requirements
UL	*Meets 3 hour fire rating for all UL functions when fronted latches used. Meets 20 minute with Square, Radius or Drive-In used
ASTM	All Weiser product meets ASTM E 331 water penetration testing

Dimensions	A	B	C
GDC9471	2 1/2"	1 1/8"	1 3/4"

WARRANTY:

Weiser™ products provide a "Lifetime Mechanical Warranty" that covers all defects in material and workmanship. For more information, please visit ca.weiserlock.com/en/warranty/.