

## METROPOLITAN BOUTIQUE SQUARE DEADBOLT - SSD9471

Box Pack Specifications



SATIN NICKEL



SATIN CHROME



POLISHED CHROME





MATTE BLACK



These finishes are available with Microban anti-microbial coating: 15 and 514



SSD9471		 20 min.	 3 Hour	Satin Nickel	Polished Chrome	Satin Chrome	Matte Black
Single Cylinder	SSD9471 SQT	<input type="checkbox"/>	<input type="checkbox"/>	<input type="checkbox"/>	<input type="checkbox"/>	<input type="checkbox"/>	<input type="checkbox"/>
Double Cylinder	SSD9471 SQT	<input type="checkbox"/>	<input type="checkbox"/>	<input type="checkbox"/>	<input type="checkbox"/>	<input type="checkbox"/>	<input type="checkbox"/>

## SPECIFICATIONS

<b>Door Prep</b>	Cross Bore 2-1/8" Edge Bore 1" Latch Face 1" x 2-1/4"
<b>Backset</b>	Adjustable to 2-3/8" or 2-3/4"
<b>Door Thickness</b>	1-3/8" - 1-3/4" doors standard. 2-1/4" doors optional
<b>Cylinder</b>	SmartKey or KW 5-pin or WS 5-pin
<b>Faceplates</b>	1" x 2 1/4" Specify round corner or square corner or drive-in
<b>Strikes</b>	1-1/8" x 2-3/4" Specify round corner or square corner
<b>Bolt</b>	1" throw. Steel.
<b>Door Handing</b>	Reversible for right or left-handed doors
<b>ANSI/BHMA</b>	A156.5 Grade 2
<b>ADA</b>	Interior turn piece meets 4.13.9 ADA requirements
<b>UL</b>	*Meets 3 hour fire rating for all UL functions when fronted latches used.
<b>ASTM</b>	All Weiser product meets ASTM E 331 water penetration testing



20 min.



3 Hour

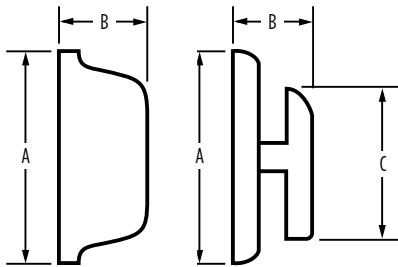

Dimensions	A	B	C
SSD9471 SQT Interior	2 <sup>17</sup> / <sub>32</sub> "	1 <sup>13</sup> / <sub>32</sub> "	1 <sup>1</sup> / <sub>16</sub> "
SSD9471 SQT Exterior	2 <sup>19</sup> / <sub>32</sub> "	<sup>15</sup> / <sub>16</sub> "	N/A

## WARRANTY:

Weiser™ products provide a "Lifetime Mechanical Warranty" that covers all defects in material and workmanship. For more information, please visit [ca.weiserlock.com/en/warranty/](http://ca.weiserlock.com/en/warranty/).