

## UPTOWN DEADBOLT - GD1471

Box Pack Specifications



SATIN NICKEL



SATIN CHROME



POLISHED CHROME



MATTE BLACK



These finishes are available with Microban anti-microbial coating: 15 and 514



GD1471		 20 min.	Satin Nickel	Polished Chrome	Satin Chrome	Matte Black
Single Cylinder	GD1471 RDT	<input type="checkbox"/>	<input type="checkbox"/>	<input type="checkbox"/>	<input type="checkbox"/>	<input type="checkbox"/>
Double Cylinder	GD1471 RDT	<input type="checkbox"/>	<input type="checkbox"/>	<input type="checkbox"/>	<input type="checkbox"/>	<input type="checkbox"/>

## SPECIFICATIONS

<b>Door Prep</b>	Cross Bore 2-1/8" Edge Bore 1" Latch Face 1" x 2-1/4"
<b>Backset</b>	Adjustable to 2-3/8" or 2-3/4"
<b>Door Thickness</b>	1-3/8" - 1-3/4" doors standard. 2-1/4" doors optional
<b>Cylinder</b>	SmartKey or KW 5-pin or WS 5-pin
<b>Faceplates</b>	1" x 2 1/4" Specify round corner or square corner or drive-in
<b>Strikes</b>	1-1/8" x 2-3/4" Specify round corner or square corner
<b>Bolt</b>	1" throw. Steel.
<b>Door Handing</b>	Reversible for right or left-handed doors
<b>ANSI/BHMA</b>	A156.5 Grade 2
<b>ADA</b>	Interior turn piece meets 4.13.9 ADA requirements
<b>UL</b>	*Meets 3 hour fire rating for all UL functions when fronted latches used.
<b>ASTM</b>	All Weiser product meets ASTM E 331 water penetration testing

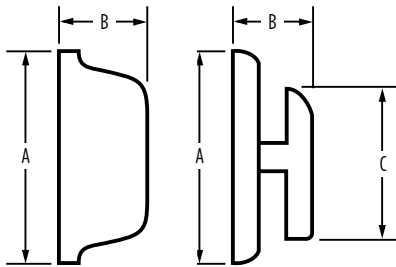

Dimensions	A	B	C
Uptown GD1471 Interior	2 5/8"	1 3/8"	1 21/32"
Uptown GD1471 Exterior	2 5/8"	9/16"	N/A

## WARRANTY:

Weiser™ products provide a "Lifetime Mechanical Warranty" that covers all defects in material and workmanship. For more information, please visit [ca.weiserlock.com/en/warranty/](http://ca.weiserlock.com/en/warranty/).